



Industrial Hygiene • Air Quality • Lead & Asbestos • Training • Health & Safety

LIMITED ASBESTOS INSPECTION REPORT

Conducted at:

MUSCATEL MIDDLE SCHOOL
NEW SHADE STRUCTURE AND BUILDING E URINAL & DRINKING
FOUNTAIN
4201 IVAR AVENUE
ROSEMEAD, CALIFORNIA 91770

Prepared for:

DR. MARIA RIOS
ASSISTANT SUPERINTENDENT OF ADMINISTRATIVE SERVICES
ROSEMEAD SCHOOL DISTRICT
3907 ROSEMEAD BOULEVARD, SUITE 220
ROSEMEAD, CALIFORNIA 91770

Prepared by:

EXECUTIVE ENVIRONMENTAL
310 EAST FOOTHILL BOULEVARD, SUITE 200
ARCADIA, CALIFORNIA 91006

Project Number EE 23-Z0046-0030
March 13, 2023

Report assembled by:

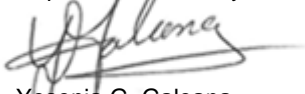

Yesenia G. Galeana
Technical Report Writer
Executive Environmental

Report generated/reviewed by:

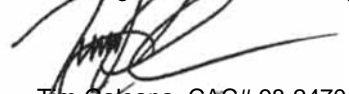

Tim Galeana, CAC# 98-2470
Senior Project Manager
Executive Environmental

TABLE OF CONTENTS

- I. EXECUTIVE SUMMARY
- II. SAMPLING METHODOLOGY
- III. SAMPLE ANALYSIS
- IV. FINDINGS
- V. CONCLUSIONS/RECOMMENDATIONS
- VI. DISCLAIMER/REPORT LIMITATIONS

APPENDICES

APPENDIX A – LABORATORY ANALYSIS REPORT

APPENDIX B – SAMPLE/ACM LOCATIONS DRAWING

APPENDIX C – STAFF CERTIFICATION

LIMITED ASBESTOS INSPECTION REPORT

Project Number: EE 23-Z0046-0030

Client: Rosemead School District
3907 Rosemead Boulevard, Suite 220
Rosemead, California 91770

Site Location: Muscatel Middle School
New Shade Structure & Building E Urinal & Drinking Fountain
4201 Ivar Avenue
Rosemead, California 91770

Site Use: School Property

Contact Person: Ms. Maria Rios
Assistant Superintendent of Administrative Services
Phone: (626) 312-2900 Ext 219

Inspection Date: February 17, 2023

Inspected By: Mr. Rhys Kuzmic
Certified Asbestos Consultant, # 09-4586

Report Assembled By: Ms. Yesenia G. Galeana
Technical Report Writer

Report Generated/Reviewed By: Mr. Tim Galeana
Certified Asbestos Consultant, # 98-2470

I. EXECUTIVE SUMMARY

Executive Environmental (EE) provided the services of Certified Asbestos Consultant (Mr. Rhys Kuzmic, CAC No. 09-4586) to conduct a limited asbestos inspection of the Campus and Building E at Muscatel Middle School located at 4201 Ivar Avenue, Rosemead, California. The inspection was conducted as a precursor to the upcoming New Shade Structure & Building E Urinal & Drinking Fountain Project. Materials suspected of containing asbestos were sampled and analyzed for the presence of asbestos. No Asbestos-Containing Materials (ACM) were identified during this inspection. *This is considered to be a limited inspection. Inspection was limited to materials and locations anticipated to be impacted by the New Shade Structure & Building E Urinal & Drinking Fountain Project, as directed by client.*

II. SAMPLING METHODOLOGY

A visual inspection of the Campus and Building E was conducted prior to the collection of any bulk samples. The visual inspection was conducted to identify and record the location and condition of the materials to be sampled. Following the visual inspection,

bulk material samples of the identified suspect asbestos-containing building materials were collected. The materials were categorized into homogeneous groupings, and each sample was assigned a unique sample number and placed into a sealed container.

Upon completion of the bulk sample collection, a chain of custody was prepared and the samples were delivered to the laboratory for analysis. AmeriSci of Carson, CA, analyzed the samples using Polarized Light Microscopy (PLM). AmeriSci is an accredited participant in the National Voluntary Laboratory Accreditation Program (NVLAP), No. 200346-0. The principles described in the current Environmental Protection Agency (EPA) 600 method were used in the preparation and analysis of the bulk samples.

Note: Inaccessible suspect asbestos materials may be located within sealed ceilings, walls, or floors; or within wall cavities, interstitials, shafts, etc. Suspect asbestos materials located in these areas must be sampled prior to any activities that might cause them to be disturbed.

III. SAMPLE ANALYSIS

Fifty (50) samples were collected during this inspection. The laboratory analysis results are identified in the following table. Materials determined not to contain asbestos are listed as "No Asbestos Detected" (NAD).

Any material found to contain more than 1% of a known asbestos substance is considered to be an asbestos-containing material (ACM). Materials falling within this category are controlled and must be handled in accordance with the California Occupational Safety & Health Administration (Cal/OSHA), EPA, and South Coast Air Quality Management District (SCAQMD) regulations.

In addition, materials which are characterized as non-ACM by EPA or other local regulatory agencies may fall within the regulatory standards of Cal/OSHA, which further regulates any materials found to contain more than 1/10 of 1%, but 1% or less, of a known asbestos substance as asbestos-containing construction materials (ACCMs). Impacting or handling ACCMs requires special employer registration, documentation, training, and personal protective equipment. When a material is to be impacted, the National Emission Standards for Hazardous Air Pollutants (NESHAPs) regulations require further testing for materials that fall within this category.

The PLM analytical protocol requires each layer of the sample to be analyzed separately. The quantity of analyses will vary based on the number of layers in a sample and whether a "positive stop" is employed. When one sample of a homogeneous area is positive, the remainder of the samples need not be analyzed because the entire homogeneous area must be considered positive.

**Sampling results begin on the next page.
The remainder of this page is blank.**

POLARIZED LIGHT MICROSCOPY (PLM) ANALYSIS DATA

Muscatel Middle School
4201 Ivar Avenue
Rosemead, California 91770

Homogeneous Material #	Material Description	Material Location	Estimated Quantity	Condition ^A	Type ^B	Friable	Percent Damaged	Sample Number	Sample Location	Analytical Results
Campus										
1	Concrete paving	Area A (Lunch area between Buildings B and D)	3,700 Square Feet	G	Misc.	No	0	2302170030RK-01	Southeast near planter	NAD ^C
								2302170030RK-02	Center-west near planter	NAD
								2302170030RK-03	Center-east near planter	NAD
								2302170030RK-04	Northwest near planter	NAD
								2302170030RK-05	Northeast near planter	NAD
2	Stucco over cinderblock	Area A (Lunch area between Buildings B and D) Planters	250 Square Feet	G	Misc.	No	<1	2302170030RK-06	Southeast planter	NAD
								2302170030RK-07	East planter	NAD
								2302170030RK-08	Northeast planter	NAD
3	Brick and mortar	Area A (Lunch area between Buildings B and D) Cap pieces on planters	60 Square Feet	G	Misc.	No	<1	2302170030RK-09	Southeast planter	Layers 1 & 2: NAD
								2302170030RK-10	Center-west planter	Layers 1 & 2: NAD
								2302170030RK-11	Northwest planter	Layers 1 & 2: NAD
4	Cinderblock and mortar (behind stucco)	Area A (Lunch area between Buildings B and D) Planters	250 Square Feet	G	Misc.	No	0	2302170030RK-12	Southeast planter	Layers 1 & 2: NAD
								2302170030RK-13	Center-west planter	Layers 1 & 2: NAD
								2302170030RK-14	Northwest planter	Layers 1 & 2: NAD

Note: This table must be used in conjunction with the entire report. This document is not to be used for contract bidding and is intended to be used to identify asbestos-containing materials and their locations only.

Sampling results continue on the next page.

^A G = Good; D = Damaged; SD = Severely Damaged

^B Misc. = Miscellaneous; Surf. = Surfacing; TSI = Thermal System Insulation

^C NAD = No Asbestos Detected.

POLARIZED LIGHT MICROSCOPY (PLM) ANALYSIS DATA

Muscatel Middle School
4201 Ivar Avenue
Rosemead, California 91770

Homogeneous Material #	Material Description	Material Location	Estimated Quantity	Condition ^D	Type ^E	Friable	Percent Damaged	Sample Number	Sample Location	Analytical Results
Campus										
5	Caulking	Area A (Lunch area between Buildings B and D) center-west planter at brick and stucco	1 Square Feet	G	Misc.	No	0	2302170030RK-15	Center-west planter at brick	NAD ^F
								2302170030RK-16	Center-west planter at brick	NAD
								2302170030RK-17	Center-west planter at stucco	NAD
6	Concrete walkway	Area B (south of Building A/X Administration)	300 Square Feet	G	Misc.	No	0	2302170030RK-18	Northwest	NAD
								2302170030RK-19	Northeast	NAD
								2302170030RK-20	South	NAD
7	Expansion joint	Area B (south of Building A/X Administration) Between concrete and building	2 Square Feet	G	Misc.	No	0	2302170030RK-21	North between concrete and building	NAD
								2302170030RK-22	North between concrete and building	NAD
								2302170030RK-23	North between concrete and building	NAD
8	Concrete walkway	Area C (walkway near main entry to Building A/X Administration)	250 Square Feet	G	Misc.	No	0	2302170030RK-24	Southwest	NAD
								2302170030RK-25	Southeast	NAD
								2302170030RK-26	Northwest	NAD

Note: This table must be used in conjunction with the entire report. This document is not to be used for contract bidding and is intended to be used to identify asbestos-containing materials and their locations only.

Sampling results continue on the next page.

^D G = Good; D = Damaged; SD = Severely Damaged

^E Misc. = Miscellaneous; Surf. = Surfacing; TSI = Thermal System Insulation

^F NAD = No Asbestos Detected.

POLARIZED LIGHT MICROSCOPY (PLM) ANALYSIS DATA

Muscatel Middle School
4201 Ivar Avenue
Rosemead, California 91770

Homogeneous Material #	Material Description	Material Location	Estimated Quantity	Condition ^G	Type ^H	Friable	Percent Damaged	Sample Number	Sample Location	Analytical Results
Campus										
9	Concrete walkway	Area D (walkway at handicap entry from parking lot east of Building D)	170 Square Feet	G	Misc.	No	0	2302170030RK-27	Southwest	NAD ^I
								2302170030RK-28	West	NAD
								2302170030RK-29	North	NAD
10	Asphalt paving	Area D (walkway at handicap entry from parking lot east of Building D) adjoining parking lot	20 Square Feet	G	Misc.	No	0	2302170030RK-30	Southeast at parking lot	NAD
								2302170030RK-31	East at parking lot	NAD
								2302170030RK-32	Northeast at parking lot	NAD

Note: This table must be used in conjunction with the entire report. This document is not to be used for contract bidding and is intended to be used to identify asbestos-containing materials and their locations only.

Sampling results continue on the next page.

^G G = Good; D = Damaged; SD = Severely Damaged

^H Misc. = Miscellaneous; Surf. = Surfacing; TSI = Thermal System Insulation

^I NAD = No Asbestos Detected.

POLARIZED LIGHT MICROSCOPY (PLM) ANALYSIS DATA

Muscatel Middle School
4201 Ivar Avenue
Rosemead, California 91770

Homogeneous Material #	Material Description	Material Location	Estimated Quantity	Condition ^J	Type ^K	Friable	Percent Damaged	Sample Number	Sample Location	Analytical Results
Building E										
11	4" Ceramic wall tile with grout and thinset	Boys' restroom (west wall) around northwest urinal (on drywall)	20 Square Feet	G	Misc.	Yes	0	2302170030RK-33	Boys' restroom, west wall	Layers 1 thru 3: NAD ^L
		Exterior south wall around drinking fountains on stucco						2302170030RK-34	Boys' restroom, west wall	Layers 1 thru 3: NAD
								2302170030RK-35	Exterior, south wall around drinking fountains	Layers 1 thru 3: NAD
12	Drywall (no joint compound)	Behind ceramic wall tile of Boys' restroom west wall around northwest urinal	10 Square Feet	G	Misc.	No	0	2302170030RK-36	Boys' restroom, west wall	NAD
								2302170030RK-37	Boys' restroom, west wall	NAD
								2302170030RK-38	Boys' restroom, west wall	NAD
13	Caulking	Boys' restroom west wall northwest urinal	1 Square Feet	G	Misc.	No	0	2302170030RK-39	West wall at northwest urinal	NAD
								2302170030RK-40	West wall at northwest urinal	NAD
								2302170030RK-41	West wall at northwest urinal	NAD

Note: This table must be used in conjunction with the entire report. This document is not to be used for contract bidding and is intended to be used to identify asbestos-containing materials and their locations only.

Sampling results continue on the next page.

^J G = Good; D = Damaged; SD = Severely Damaged

^K Misc. = Miscellaneous; Surf. = Surfacing; TSI = Thermal System Insulation

^L NAD = No Asbestos Detected.

POLARIZED LIGHT MICROSCOPY (PLM) ANALYSIS DATA

Muscatel Middle School
4201 Ivar Avenue
Rosemead, California 91770

Homogeneous Material #	Material Description	Material Location	Estimated Quantity	Condition ^M	Type ^N	Friable	Percent Damaged	Sample Number	Sample Location	Analytical Results
Building E										
14	Stucco	Behind ceramic wall tile of exterior south wall around drinking fountains	10 Square Feet	G	Surf.	No	0	2302170030RK-42	South wall around drinking fountains	NAD ^O
								2302170030RK-43	South wall around drinking fountains	NAD
								2302170030RK-44	South wall around drinking fountains	NAD
15	Cementitious material	Layer behind ceramic wall tile and stucco of exterior south wall around drinking fountain	10 Square Feet	G	Misc.	No	0	2302170030RK-45	South wall around drinking fountains	NAD
								2302170030RK-46	South wall around drinking fountains	NAD
								2302170030RK-47	South wall around drinking fountains	NAD
16	Vapor barrier paper	Behind cementitious material (layer behind ceramic wall tile and stucco) of exterior south wall around drinking fountain	10 Square Feet	G	Misc.	No	0	2302170030RK-48	South wall around drinking fountains	NAD
								2302170030RK-49	South wall around drinking fountains	NAD
								2302170030RK-50	South wall around drinking fountains	NAD

Note: This table must be used in conjunction with the entire report. This document is not to be used for contract bidding and is intended to be used to identify asbestos-containing materials and their locations only.

The remainder of this page is blank.

^M G = Good; D = Damaged; SD = Severely Damaged

^N Misc. = Miscellaneous; Surf. = Surfacing; TSI = Thermal System Insulation

^O NAD = No Asbestos Detected.

IV. FINDINGS

EE conducted a limited asbestos inspection of the Campus and Building E at Muscatel Middle School located at 4201 Ivar Avenue, Rosemead, California.

Sixteen (16) homogeneous material groups were identified during the visual property inspection. Fifty (50) samples of suspect asbestos-containing materials were collected and delivered to AmeriSci of Carson, for analysis. The homogeneous area and sampling results are listed on the table in Section III.

The analytical data revealed that the sampled materials do not contain asbestos.

V. CONCLUSIONS/RECOMMENDATIONS

No asbestos-containing materials were identified during this inspection. Activities involving the inspected materials may proceed as normal construction actions. If suspect asbestos materials that were not sampled are to be disturbed, additional sampling will be required.

If you have any questions, please call Mr. Tim Galeana at 626-441-7050. We are glad we could be of service to you.

VI. DISCLAIMER/REPORT LIMITATIONS

All reports and recommendations are based on conditions and practices observed and information made available to Executive Environmental (EE) by the client and the designated sites/facilities on the days sampling was conducted. This report does not purport to set forth all hazards, nor to indicate that other hazards do not exist. No responsibility is assumed by EE for the control or correction of conditions or practices existing at the facilities, or at any other premises surveyed by EE, for and on the behalf of the client. Services provided by EE shall be governed by the standard of practice for professional services measured at the time those services are rendered.

All information contained in this report is proprietary and limited to the scope of services, parameters of the analytical methods used and the conditions present at the time of this inspection. Any references to quantities are considered estimates and are not to be construed as actual.

APPENDIX A – LABORATORY ANALYSIS REPORT



Please Reply To:

AmeriSci Los Angeles

24416 S. Main Street, Ste 308
Carson, California 90745
TEL: (310) 834-4868 • FAX: (310) 834-4772

LABORATORY ELECTRONIC TRANSMITTAL

To: Yesenia Galeana
Executive Environmental Services Corporatio
Fax #:
Email: info@execenv.com, ygaleana@execenv.com

From: Dennis Liu
AmeriSci Job #: 923021364
Subject: PLM 3 day Results
Client Project: 23-Z0046-0030; Campus

Date: Thursday, February 23, 2023
Time: 10:36:52
Comments:

Number of Pages: _____
(including cover sheet)

NOTE: Attached report is to be considered preliminary until final review with accompanying analysis summary letter is issued.

CONFIDENTIALITY NOTICE: Unless otherwise indicated, the information contained in this communication is confidential information intended for use of the individual named above. If the reader of this communication is not the intended recipient, you are hereby notified that any dissemination, distribution or copying of this communication is prohibited. If you have received this communication in error, please immediately notify the sender by telephone and return the original message to the above address via the US Postal Service at our expense. Samples are disposed of in 60 days or unless otherwise instructed by the protocol or special instructions in writing. Thank you.

Certified Analysis Service 24 Hours A Day • 7 Days A Week Competitive Prices
visit our web site - www.amerisci.com

Boston • Los Angeles • New York • Richmond

**AmeriSci Los Angeles**

24416 S. Main Street, Ste 308
Carson, California 90745
TEL: (310) 834-4868 • FAX: (310) 834-4772

PLM Bulk Asbestos Report

Executive Environmental Services Corporation
Attn: Yesenia Galeana
310 East Foothill Blvd.
Suite 200
Arcadia, CA 91006

Date Received 02/18/23
Date Examined 02/20/23
RE: 23-Z0046-0030; Campus

AmeriSci Job # 923021364
P.O. #
Page 1 **of** 11

Client No. / HGA	Lab No.	Asbestos Present	Total % Asbestos
2302170030RK-01	923021364-01	No	NAD
Location: Area A, SE Near Planter / Concrete Paving / Area A (Lunch Area Between Bldg B And Bldg D)			(by CVES) by Dennis Liu on 02/20/23
Analyst Description: Gray, Heterogeneous, Non-Fibrous, Cementitious, Concrete Asbestos Types: Other Material: Non-fibrous 100%			
2302170030RK-02	923021364-02	No	NAD
Location: Area A, Center-West Near Planter / Concrete Paving / Area A (Lunch Area Between Bldg B And Bldg D)			(by CVES) by Dennis Liu on 02/20/23
Analyst Description: Gray, Heterogeneous, Non-Fibrous, Cementitious, Concrete Asbestos Types: Other Material: Non-fibrous 100%			
2302170030RK-03	923021364-03	No	NAD
Location: Area A, Center-East Near Planter / Concrete Paving / Area A (Lunch Area Between Bldg B And Bldg D)			(by CVES) by Dennis Liu on 02/20/23
Analyst Description: Gray, Heterogeneous, Non-Fibrous, Cementitious, Concrete Asbestos Types: Other Material: Non-fibrous 100%			
2302170030RK-04	923021364-04	No	NAD
Location: Area A, NW Near Planter / Concrete Paving			(by CVES) by Dennis Liu on 02/20/23
Analyst Description: Gray, Heterogeneous, Non-Fibrous, Cementitious, Concrete Asbestos Types: Other Material: Non-fibrous 100%			
2302170030RK-05	923021364-05	No	NAD
Location: Area A, NE Near Planter / Concrete Paving			(by CVES) by Dennis Liu on 02/20/23
Analyst Description: Gray, Heterogeneous, Non-Fibrous, Concrete Asbestos Types: Other Material: Non-fibrous 100%			

PLM Bulk Asbestos Report

23-Z0046-0030; Campus

Client No. / HGA	Lab No.	Asbestos Present	Total % Asbestos
2302170030RK-06	923021364-06	No	NAD
Location: Area A, SE Planter / Stucco Over Cinderblock / Area A (Lunch Area Between Bldg B And Bldg D) Planters			(by CVES) by Dennis Liu on 02/20/23
Analyst Description: White, Heterogeneous, Non-Fibrous, Cementitious, Stucco Asbestos Types: Other Material: Non-fibrous 100%			
2302170030RK-07	923021364-07	No	NAD
Location: Area A, East Planter / Stucco Over Cinderblock / Area A (Lunch Area Between Bldg B And Bldg D) Planters			(by CVES) by Dennis Liu on 02/20/23
Analyst Description: White, Heterogeneous, Non-Fibrous, Cementitious, Stucco Asbestos Types: Other Material: Non-fibrous 100%			
2302170030RK-08	923021364-08	No	NAD
Location: Area A, NE Planter / Stucco Over Cinderblock / Area A (Lunch Area Between Bldg B And Bldg D) Planters			(by CVES) by Dennis Liu on 02/20/23
Analyst Description: White, Heterogeneous, Non-Fibrous, Cementitious, Stucco Asbestos Types: Other Material: Non-fibrous 100%			
2302170030RK-09	923021364-09L1	No	NAD
Location: Area A, SE Planter / Brick And Mortar / Area A (Lunch Area Between Bldg B And Bldg D) Cap Piece On Planters			(by CVES) by Dennis Liu on 02/20/23
Analyst Description: Red, Heterogeneous, Non-Fibrous, Cementitious, Brick Asbestos Types: Other Material: Non-fibrous 100%			
2302170030RK-09	923021364-09L2	No	NAD
Location: Area A, SE Planter / Brick And Mortar / Area A (Lunch Area Between Bldg B And Bldg D) Cap Piece On Planters			(by CVES) by Dennis Liu on 02/20/23
Analyst Description: Gray, Heterogeneous, Non-Fibrous, Cementitious, Mortar Asbestos Types: Other Material: Non-fibrous 100%			
2302170030RK-10	923021364-10L1	No	NAD
Location: Area A, Center-West Planter / Brick And Mortar / Area A (Lunch Area Between Bldg B And Bldg D) Cap Piece On Planters			(by CVES) by Dennis Liu on 02/20/23
Analyst Description: Red, Heterogeneous, Non-Fibrous, Brick Asbestos Types: Other Material: Non-fibrous 100%			

PLM Bulk Asbestos Report

23-Z0046-0030; Campus

Client No. / HGA	Lab No.	Asbestos Present	Total % Asbestos
2302170030RK-10	923021364-10L2	No	NAD
Location: Area A, Center-West Planter / Brick And Mortar / Area A (Lunch Area Between Bldg B And Bldg D) Cap Piece On Planters			(by CVES) by Dennis Liu on 02/20/23
Analyst Description: Gray, Heterogeneous, Non-Fibrous, Mortar			
Asbestos Types:			
Other Material: Non-fibrous 100%			
2302170030RK-11	923021364-11L1	No	NAD
Location: Area A, NW Planter / Brick And Mortar / Area A (Lunch Area Between Bldg B And Bldg D) Cap Piece On Planters			(by CVES) by Dennis Liu on 02/20/23
Analyst Description: Red, Heterogeneous, Non-Fibrous, Brick			
Asbestos Types:			
Other Material: Non-fibrous 100%			
2302170030RK-11	923021364-11L2	No	NAD
Location: Area A, NW Planter / Brick And Mortar / Area A (Lunch Area Between Bldg B And Bldg D) Cap Piece On Planters			(by CVES) by Dennis Liu on 02/20/23
Analyst Description: Gray, Heterogeneous, Non-Fibrous, Mortar			
Asbestos Types:			
Other Material: Non-fibrous 100%			
2302170030RK-12	923021364-12L1	No	NAD
Location: Area A, SE Planter / Cinderblock And Mortar (Behind Stucco) / Area A (Lunch Area Between Bldg B And Bldg D) Planters			(by CVES) by Dennis Liu on 02/20/23
Analyst Description: Gray, Heterogeneous, Non-Fibrous, Cementitious, Cinderblock			
Asbestos Types:			
Other Material: Non-fibrous 100%			
2302170030RK-12	923021364-12L2	No	NAD
Location: Area A, SE Planter / Cinderblock And Mortar (Behind Stucco) / Area A (Lunch Area Between Bldg B And Bldg D) Planters			(by CVES) by Dennis Liu on 02/20/23
Analyst Description: Gray, Heterogeneous, Non-Fibrous, Cementitious, Mortar			
Asbestos Types:			
Other Material: Cellulose 100%			
2302170030RK-13	923021364-13L1	No	NAD
Location: Area A, Center-West Planter / Cinderblock And Mortar (Behind Stucco) / Area A (Lunch Area Between Bldg B And Bldg D) Planters			(by CVES) by Dennis Liu on 02/20/23
Analyst Description: Gray, Heterogeneous, Non-Fibrous, Cementitious, Cinderblock			
Asbestos Types:			
Other Material: Non-fibrous 100%			

PLM Bulk Asbestos Report

23-Z0046-0030; Campus

Client No. / HGA	Lab No.	Asbestos Present	Total % Asbestos
2302170030RK-13	923021364-13L2	No	NAD
Location: Area A, Center-West Planter / Cinderblock And Mortar (Behind Stucco) / Area A (Lunch Area Between Bldg B And Bldg D) Planters			(by CVES) by Dennis Liu on 02/20/23
Analyst Description: Gray, Heterogeneous, Non-Fibrous, Cementitious, Mortar			
Asbestos Types:			
Other Material: Non-fibrous 100%			
2302170030RK-14	923021364-14L1	No	NAD
Location: Area A, NW Planter / Cinderblock And Mortar (Behind Stucco) / Area A (Lunch Area Between Bldg B And Bldg D) Planters			(by CVES) by Dennis Liu on 02/20/23
Analyst Description: Gray, Heterogeneous, Non-Fibrous, Cementitious, Cinderblock			
Asbestos Types:			
Other Material: Non-fibrous 100%			
2302170030RK-14	923021364-14L2	No	NAD
Location: Area A, NW Planter / Cinderblock And Mortar (Behind Stucco) / Area A (Lunch Area Between Bldg B And Bldg D) Planters			(by CVES) by Dennis Liu on 02/20/23
Analyst Description: Gray, Heterogeneous, Non-Fibrous, Mortar			
Asbestos Types:			
Other Material: Non-fibrous 100%			
2302170030RK-15	923021364-15	No	NAD
Location: Area A, Center-West Planter At Brick / Caulking / Area A (Lunch Area Between Bldg B And Bldg D) Center-West Planter At Brick And Stucco			(by CVES) by Dennis Liu on 02/20/23
Analyst Description: White, Heterogeneous, Non-Fibrous, Caulk			
Asbestos Types:			
Other Material: Non-fibrous 100%			
2302170030RK-16	923021364-16	No	NAD
Location: Area A, Center-West Planter At Brick / Caulking / Area A (Lunch Area Between Bldg B And Bldg D) Center-West Planter At Brick And Stucco			(by CVES) by Dennis Liu on 02/20/23
Analyst Description: White, Heterogeneous, Non-Fibrous, Caulk			
Asbestos Types:			
Other Material: Non-fibrous 100%			
2302170030RK-17	923021364-17	No	NAD
Location: Area A, Center-West Planter At Stucco / Caulking / Area A (Lunch Area Between Bldg B And Bldg D) Center-West Planter At Brick And Stucco			(by CVES) by Dennis Liu on 02/20/23
Analyst Description: White, Heterogeneous, Non-Fibrous, Caulk			
Asbestos Types:			
Other Material: Non-fibrous 100%			

PLM Bulk Asbestos Report

23-Z0046-0030; Campus

Client No. / HGA	Lab No.	Asbestos Present	Total % Asbestos
2302170030RK-18	923021364-18	No	NAD
Location: Area B, NW / Concrete Walkway / Area B (South Of Bldg A/X Administration)			(by CVES) by Dennis Liu on 02/20/23
Analyst Description: Gray, Heterogeneous, Non-Fibrous, Cementitious, Concrete			
Asbestos Types:			
Other Material: Non-fibrous 100%			
2302170030RK-19	923021364-19	No	NAD
Location: Area B, NE / Concrete Walkway / Area B (South Of Bldg A/X Administration)			(by CVES) by Dennis Liu on 02/20/23
Analyst Description: Gray, Heterogeneous, Non-Fibrous, Cementitious, Concrete			
Asbestos Types:			
Other Material: Non-fibrous 100%			
2302170030RK-20	923021364-20	No	NAD
Location: Area B, South / Concrete Walkway / Area B (South Of Bldg A/X Administration)			(by CVES) by Dennis Liu on 02/20/23
Analyst Description: Gray, Heterogeneous, Non-Fibrous, Cementitious, Concrete			
Asbestos Types:			
Other Material: Non-fibrous 100%			
2302170030RK-21	923021364-21	No	NAD
Location: Area B, North Between Concrete And Building / Expansion Joint / Area B (South Of Bldg A/X Administration) Between Concrete And Building			(by CVES) by Dennis Liu on 02/20/23
Analyst Description: Brown, Heterogeneous, Non-Fibrous, Expansion Joint			
Asbestos Types:			
Other Material: Cellulose 60%, Non-fibrous 40%			
2302170030RK-22	923021364-22	No	NAD
Location: Area B, North Between Concrete And Building / Expansion Joint / Area B (South Of Bldg A/X Administration) Between Concrete And Building			(by CVES) by Dennis Liu on 02/20/23
Analyst Description: Brown, Heterogeneous, Non-Fibrous, Expansion Joint			
Asbestos Types:			
Other Material: Cellulose 60%, Non-fibrous 40%			
2302170030RK-23	923021364-23	No	NAD
Location: Area B, North Between Concrete And Building / Expansion Joint / Area B (South Of Bldg A/X Administration) Between Concrete And Building			(by CVES) by Dennis Liu on 02/20/23
Analyst Description: Brown, Heterogeneous, Non-Fibrous, Expansion Joint			
Asbestos Types:			
Other Material: Cellulose 60%, Non-fibrous 40%			

PLM Bulk Asbestos Report

23-Z0046-0030; Campus

Client No. / HGA	Lab No.	Asbestos Present	Total % Asbestos
2302170030RK-24	923021364-24	No	NAD
Location: Area C, SW / Concrete Walkway / Area C (Walkway Near Main Entry To Bldg A/X Administration)			(by CVES) by Dennis Liu on 02/20/23
Analyst Description: Gray, Heterogeneous, Non-Fibrous, Cementitious, Concrete			
Asbestos Types:			
Other Material: Non-fibrous 100%			
2302170030RK-25	923021364-25	No	NAD
Location: Area C, SE / Concrete Walkway / Area C (Walkway Near Main Entry To Bldg A/X Administration)			(by CVES) by Dennis Liu on 02/20/23
Analyst Description: Gray, Heterogeneous, Non-Fibrous, Cementitious, Concrete			
Asbestos Types:			
Other Material: Non-fibrous 100%			
2302170030RK-26	923021364-26	No	NAD
Location: Area C, NW / Concrete Walkway / Area C (Walkway Near Main Entry To Bldg A/X Administration)			(by CVES) by Dennis Liu on 02/20/23
Analyst Description: Gray, Heterogeneous, Non-Fibrous, Cementitious, Concrete			
Asbestos Types:			
Other Material: Non-fibrous 100%			
2302170030RK-27	923021364-27	No	NAD
Location: Area D, SW / Concrete Walkway / Area D (Walkway At Handicap Entry From Parking Lot East Of Bldg D)			(by CVES) by Dennis Liu on 02/20/23
Analyst Description: Gray, Heterogeneous, Non-Fibrous, Cementitious, Concrete			
Asbestos Types:			
Other Material: Non-fibrous 100%			
2302170030RK-28	923021364-28	No	NAD
Location: Area D, West / Concrete Walkway / Area D (Walkway At Handicap Entry From Parking Lot East Of Bldg D)			(by CVES) by Dennis Liu on 02/20/23
Analyst Description: Gray, Heterogeneous, Non-Fibrous, Cementitious, Concrete			
Asbestos Types:			
Other Material: Non-fibrous 100%			
2302170030RK-29	923021364-29	No	NAD
Location: Area D, North / Concrete Walkway / Area D (Walkway At Handicap Entry From Parking Lot East Of Bldg D)			(by CVES) by Dennis Liu on 02/20/23
Analyst Description: Gray, Heterogeneous, Non-Fibrous, Cementitious, Concrete			
Asbestos Types:			
Other Material: Non-fibrous 100%			

PLM Bulk Asbestos Report

23-Z0046-0030; Campus

Client No. / HGA	Lab No.	Asbestos Present	Total % Asbestos
2302170030RK-30	923021364-30	No	NAD
Location: Area D, SE At Parking Lot / Asphalt Paving / Area D (Walkway At Handicap Entry From Parking Lot East Of Bldg D) Ajoining Parking Lot			(by CVES) by Dennis Liu on 02/20/23
Analyst Description: Black, Heterogeneous, Non-Fibrous, Asphalt			
Asbestos Types:			
Other Material: Non-fibrous 100%			
2302170030RK-31	923021364-31	No	NAD
Location: Area D, East At Parking Lot / Asphalt Paving / Area D (Walkway At Handicap Entry From Parking Lot East Of Bldg D) Ajoining Parking Lot			(by CVES) by Dennis Liu on 02/20/23
Analyst Description: Black, Heterogeneous, Non-Fibrous, Asphalt			
Asbestos Types:			
Other Material: Non-fibrous 100%			
2302170030RK-32	923021364-32	No	NAD
Location: Area D, NE At Parking Lot / Asphalt Paving / Area D (Walkway At Handicap Entry From Parking Lot East Of Bldg D) Ajoining Parking Lot			(by CVES) by Dennis Liu on 02/20/23
Analyst Description: Black, Heterogeneous, Non-Fibrous, Asphalt			
Asbestos Types:			
Other Material: Non-fibrous 100%			
2302170030RK-33	923021364-33L1	No	NAD
Location: Boy's Restroom, West Wall / 4" Ceramic Wall Tile With Grout And Thinset / Boy's Restroom West Wall Around NW Urinal On Drywall Exterior South Wall Around Drinking Fountains On Stucco			(by CVES) by Dennis Liu on 02/20/23
Analyst Description: White, Heterogeneous, Non-Fibrous, Ceramic Tile			
Asbestos Types:			
Other Material: Non-fibrous 100%			
2302170030RK-33	923021364-33L2	No	NAD
Location: Boy's Restroom, West Wall / 4" Ceramic Wall Tile With Grout And Thinset / Boy's Restroom West Wall Around NW Urinal On Drywall Exterior South Wall Around Drinking Fountains On Stucco			(by CVES) by Dennis Liu on 02/20/23
Analyst Description: Gray, Heterogeneous, Non-Fibrous, Grout			
Asbestos Types:			
Other Material: Non-fibrous 100%			
2302170030RK-33	923021364-33L3	No	NAD
Location: Boy's Restroom, West Wall / 4" Ceramic Wall Tile With Grout And Thinset / Boy's Restroom West Wall Around NW Urinal On Drywall Exterior South Wall Around Drinking Fountains On Stucco			(by CVES) by Dennis Liu on 02/20/23
Analyst Description: White, Heterogeneous, Non-Fibrous, Thinset			
Asbestos Types:			
Other Material: Non-fibrous 100%			

PLM Bulk Asbestos Report

23-Z0046-0030; Campus

Client No. / HGA	Lab No.	Asbestos Present	Total % Asbestos
2302170030RK-34	923021364-34L1	No	NAD
Location: Boy's Restroom, West Wall / 4" Ceramic Wall Tile With Grout And Thinset / Boy's Restroom West Wall Around NW Urinal On Drywall Exterior South Wall Around Drinking Fountains On Stucco			(by CVES) by Dennis Liu on 02/20/23
Analyst Description: White, Heterogeneous, Non-Fibrous, Ceramic Tile Asbestos Types: Other Material: Non-fibrous 100%			
2302170030RK-34	923021364-34L2	No	NAD
Location: Boy's Restroom, West Wall / 4" Ceramic Wall Tile With Grout And Thinset / Boy's Restroom West Wall Around NW Urinal On Drywall Exterior South Wall Around Drinking Fountains On Stucco			(by CVES) by Dennis Liu on 02/20/23
Analyst Description: Gray, Heterogeneous, Non-Fibrous, Grout Asbestos Types: Other Material: Non-fibrous 100%			
2302170030RK-34	923021364-34L3	No	NAD
Location: Boy's Restroom, West Wall / 4" Ceramic Wall Tile With Grout And Thinset / Boy's Restroom West Wall Around NW Urinal On Drywall Exterior South Wall Around Drinking Fountains On Stucco			(by CVES) by Dennis Liu on 02/20/23
Analyst Description: White, Heterogeneous, Non-Fibrous, Thinset Asbestos Types: Other Material: Non-fibrous 100%			
2302170030RK-35	923021364-35L1	No	NAD
Location: Exterior, South Wall Around Drinking Fountains / 4" Ceramic Wall Tile With Grout And Thinset / Boy's Restroom West Wall Around NW Urinal On Drywall Exterior South Wall Around Drinking Fountains On Stucco			(by CVES) by Dennis Liu on 02/20/23
Analyst Description: White, Heterogeneous, Non-Fibrous, Ceramic Tile Asbestos Types: Other Material: Non-fibrous 100%			
2302170030RK-35	923021364-35L2	No	NAD
Location: Exterior, South Wall Around Drinking Fountains / 4" Ceramic Wall Tile With Grout And Thinset / Boy's Restroom West Wall Around NW Urinal On Drywall Exterior South Wall Around Drinking Fountains On Stucco			(by CVES) by Dennis Liu on 02/20/23
Analyst Description: Gray, Heterogeneous, Non-Fibrous, Grout Asbestos Types: Other Material: Non-fibrous 100%			
2302170030RK-35	923021364-35L3	No	NAD
Location: Exterior, South Wall Around Drinking Fountains / 4" Ceramic Wall Tile With Grout And Thinset / Boy's Restroom West Wall Around NW Urinal On Drywall Exterior South Wall Around Drinking Fountains On Stucco			(by CVES) by Dennis Liu on 02/20/23
Analyst Description: White, Heterogeneous, Non-Fibrous, Thinset Asbestos Types: Other Material: Non-fibrous 100%			

PLM Bulk Asbestos Report

23-Z0046-0030; Campus

Client No. / HGA	Lab No.	Asbestos Present	Total % Asbestos
2302170030RK-36	923021364-36	No	NAD
Location: Boy's Restroom, West Wall / Drywall No Joint Compound (Behind Ceramic Wall Tile) / Boy's Restroom, West Wall Around NW Urinal			(by CVES) by Dennis Liu on 02/20/23
Analyst Description: Brown/White, Heterogeneous, Fibrous, Drywall			
Asbestos Types:			
Other Material: Cellulose 20%, Non-fibrous 80%			
2302170030RK-37	923021364-37	No	NAD
Location: Boy's Restroom, West Wall / Drywall No Joint Compound (Behind Ceramic Wall Tile) / Boy's Restroom, West Wall Around NW Urinal			(by CVES) by Dennis Liu on 02/20/23
Analyst Description: Brown/White, Heterogeneous, Fibrous, Drywall			
Asbestos Types:			
Other Material: Cellulose 20%, Non-fibrous 80%			
2302170030RK-38	923021364-38	No	NAD
Location: Boy's Restroom, West Wall / Drywall No Joint Compound (Behind Ceramic Wall Tile) / Boy's Restroom, West Wall Around NW Urinal			(by CVES) by Dennis Liu on 02/20/23
Analyst Description: Brown/White, Heterogeneous, Fibrous, Drywall			
Asbestos Types:			
Other Material: Cellulose 20%, Non-fibrous 80%			
2302170030RK-39	923021364-39	No	NAD
Location: Boy's Restroom, West Wall At NW Urinal / Caulking Around Urinal / Boy's Restroom, West Wall NW Urinal			(by CVES) by Dennis Liu on 02/20/23
Analyst Description: White, Heterogeneous, Non-Fibrous, Caulk			
Asbestos Types:			
Other Material: Non-fibrous 100%			
2302170030RK-40	923021364-40	No	NAD
Location: Boy's Restroom, West Wall At NW Urinal / Caulking Around Urinal / Boy's Restroom, West Wall NW Urinal			(by CVES) by Dennis Liu on 02/20/23
Analyst Description: White, Heterogeneous, Non-Fibrous, Caulk			
Asbestos Types:			
Other Material: Non-fibrous 100%			
2302170030RK-41	923021364-41	No	NAD
Location: Boy's Restroom, West Wall At NW Urinal / Caulking Around Urinal / Boy's Restroom, West Wall NW Urinal			(by CVES) by Dennis Liu on 02/20/23
Analyst Description: White, Heterogeneous, Non-Fibrous, Caulk			
Asbestos Types:			
Other Material: Non-fibrous 100%			

PLM Bulk Asbestos Report

23-Z0046-0030; Campus

Client No. / HGA	Lab No.	Asbestos Present	Total % Asbestos
2302170030RK-42	923021364-42	No	NAD
Location: Exterior, South Wall Around Drinking Fountains / Stucco (Behind Ceramic Wall Tile) / Exterior South Wall Around Drinking Fountains			(by CVES) by Dennis Liu on 02/20/23
Analyst Description: Gray, Heterogeneous, Non-Fibrous, Cementitious, Stucco			
Asbestos Types:			
Other Material: Non-fibrous 100%			
2302170030RK-43	923021364-43	No	NAD
Location: Exterior, South Wall Around Drinking Fountains / Stucco (Behind Ceramic Wall Tile) / Exterior South Wall Around Drinking Fountains			(by CVES) by Dennis Liu on 02/20/23
Analyst Description: Gray, Heterogeneous, Non-Fibrous, Cementitious, Stucco			
Asbestos Types:			
Other Material: Non-fibrous 100%			
2302170030RK-44	923021364-44	No	NAD
Location: Exterior, South Wall Around Drinking Fountains / Stucco (Behind Ceramic Wall Tile) / Exterior South Wall Around Drinking Fountains			(by CVES) by Dennis Liu on 02/20/23
Analyst Description: Gray, Heterogeneous, Non-Fibrous, Cementitious, Stucco			
Asbestos Types:			
Other Material: Non-fibrous 100%			
2302170030RK-45	923021364-45	No	NAD
Location: Exterior, South Wall Around Drinking Fountains / Cementitious Layer Behind Stucco (Behind Ceramic Wall Tiles) / Exterior South Wall Around Drinking Fountains			(by CVES) by Dennis Liu on 02/20/23
Analyst Description: Gray, Heterogeneous, Non-Fibrous, Cementitious, Cementitious Material			
Asbestos Types:			
Other Material: Non-fibrous 100%			
2302170030RK-46	923021364-46	No	NAD
Location: Exterior, South Wall Around Drinking Fountains / Cementitious Layer Behind Stucco (Behind Ceramic Wall Tiles) / Exterior South Wall Around Drinking Fountains			(by CVES) by Dennis Liu on 02/20/23
Analyst Description: Gray, Heterogeneous, Non-Fibrous, Cementitious, Cementitious Material			
Asbestos Types:			
Other Material: Non-fibrous 100%			
2302170030RK-47	923021364-47	No	NAD
Location: Exterior, South Wall Around Drinking Fountains / Cementitious Layer Behind Stucco (Behind Ceramic Wall Tiles) / Exterior South Wall Around Drinking Fountains			(by CVES) by Dennis Liu on 02/20/23
Analyst Description: Gray, Heterogeneous, Non-Fibrous, Cementitious, Cementitious Material			
Asbestos Types:			
Other Material: Non-fibrous 100%			

PLM Bulk Asbestos Report

23-Z0046-0030; Campus

Client No. / HGA	Lab No.	Asbestos Present	Total % Asbestos
2302170030RK-48	923021364-48	No	NAD
Location: Exterior, South Wall Around Drinking Fountains / Vapor Barrier Paper-2 Types (Behind Ceramic Layer) / Exterior South Wall Around Drinking Fountains			(by CVES) by Dennis Liu on 02/20/23
Analyst Description: Black/Brown, Heterogeneous, Non-Fibrous, Vapor Barrier Asbestos Types: Other Material: Cellulose 70%, Non-fibrous 30%			
2302170030RK-49	923021364-49	No	NAD
Location: Exterior, South Wall Around Drinking Fountains / Vapor Barrier Paper-2 Types (Behind Ceramic Layer) / Exterior South Wall Around Drinking Fountains			(by CVES) by Dennis Liu on 02/20/23
Analyst Description: Black/Brown, Heterogeneous, Non-Fibrous, Vapor Barrier Asbestos Types: Other Material: Cellulose 70%, Non-fibrous 30%			
2302170030RK-50	923021364-50	No	NAD
Location: Exterior, South Wall Around Drinking Fountains / Vapor Barrier Paper-2 Types (Behind Ceramic Layer) / Exterior South Wall Around Drinking Fountains			(by CVES) by Dennis Liu on 02/20/23
Analyst Description: Black/Brown, Heterogeneous, Non-Fibrous, Vapor Barrier Asbestos Types: Other Material: Cellulose 70%, Non-fibrous 30%			

Reporting Notes:

Analyzed by: Dennis Liu
Date: 2/20/2023



Reviewed by: Patricia Weakley



*NAD = no asbestos detected; Detection Limit <1%; Reporting Limits: CVES = 1%, 400 Pt Ct = 0.25%, 1000 Pt Ct = 0.1%; NA = not analyzed; NA/PS = not analyzed / positive stop; NVA = No Visible Asbestos; PLM (polarized light microscopy) Bulk Asbestos Analysis by EPA 600/R-93/116, including requirements for EPA 600/M4-82-020 per 40 CFR 763 (NVLAP Lab #200346-0); Note: PLM is not consistently reliable in detecting asbestos in floor coverings and similar NOB materials. TEM is currently the only method that can be used to determine if this material can be considered or treated as non-asbestos-containing in New York State (also see EPA Advisory for floor tile, FR 59, 146, 38970, 8/1/94). NIST Accreditation requirements mandate that this report must not be reproduced except in full with the approval of the laboratory. This PLM report relates ONLY to the items tested.



Industrial Hygiene Laboratory Submittal Asbestos -- PLM

Originating Office

☒ 310 E. Foothill Blvd., Suite 200
Arcadia, CA 91006
Phone: 626.441.7050
Fax: 626.441.0016

Lab Submitted to:

☒ AmeriSci
☐ EMLab (Glendale)
☐ LA Testing

☒ Routine
(3 Working Days)

☐ RUSH (surcharges may apply)
Circle 6 24 48 3 to 5
One hours hours hours days

Project #:
23-Z0046-0030

Sampled by:
Rhys Kuzmic

Site Zip Code:
91770

Sample Date:
02/17/2023

Page 1 of 9

The receiving Laboratory is required to complete the following:

1. All invoices are to be sent to: 310 E. Foothill Blvd., Suite 200, Arcadia, CA 91006 with a copy of the lab report.
2. Analyze all samples by PLM by EPA 600/R-93/116.
3. Stop analysis of homogeneous groups at first positive that is greater than or equal to 1.0%

Building Name: Campus

4. All lab reports and invoices are to contain the Project Number from above.
5. Unsigned and reports marked draft are unacceptable.
6. Report to the attention of: Yesenia Galeana, Phone: (562) 889-1327

Optional Items to be completed by the laboratory (if check marked): ☒

Email Report to: ☒ Info@execenv.com ☒ Other: ygaleana@execenv.com

☒ US Mail Report to: ☒ Originating office check marked above ☐ Other:

☐ Alternate billing address:

Sample No.:	Sample Location - Include Room information where appropriate	Material Description	Homogeneous Location	No.	Quantity	Percent Damaged
-01	Area A, SE near planter	Concrete Paving	Area A (Lunch area between Bldg B and Bldg D)	1	3,700 sq ft	0
-02	Area A, center-west near planter					
-03	Area A, center-east near planter					
-04	Area A, NW near planter					
-05	Area A, NE near planter					

Notes:

Released By, Date, & Time: Rhys Kuz 02/18/2023 1:05PM	Received By, Date, & Time: [Signature] 2/18/2023 1:10 PM	Released By, Date, & Time:
---	--	----------------------------



Industrial Hygiene Laboratory Submittal Asbestos -- PLM

Originating Office

☒ 310 E. Foothill Blvd., Suite 200
Arcadia, CA 91006
Phone: 626.441.7050
Fax: 626.441.0016

Lab Submitted to:

☒ AmeriSci
☐ EMLab (Glendale)
☐ LA Testing

☒ Routine
(3 Working Days)

☐ RUSH (surcharges may apply)
Circle 6 24 48 3 to 5
One hours hours hours days

Project #:
23-Z0046-0030

Sampled by:
Rhys Kuzmic

Site Zip Code:
91770

Sample Date:
02/17/2023

Page 2 of 9

The receiving Laboratory is required to complete the following:

1. All invoices are to be sent to: 310 E. Foothill Blvd., Suite 200, Arcadia, CA 91006 with a copy of the lab report.
2. Analyze all samples by PLM by EPA 600/R-93/116.
3. Stop analysis of homogeneous groups at first positive that is greater than or equal to 1.0%

Building Name: Campus

4. All lab reports and invoices are to contain the Project Number from above.
5. Unsigned and reports marked draft are unacceptable.
6. Report to the attention of: Yesenia Galeana, Phone: (562) 889-1327

Optional Items to be completed by the laboratory (if check marked): ☒

Email Report to: ☒ Info@execenv.com ☒ Other: ygaleana@execenv.com

☒ US Mail Report to: ☒ Originating office check marked above ☐ Other:

☐ Alternate billing address:

Sample No.:	Sample Location - Include Room information where appropriate	Material Description	Homogeneous Location	No.	Quantity	Percent Damaged
-06	Area A, SE planter	Stucco over cinderblock	Area A (Lunch area between Bldg B and Bldg D) planters	2	250SR	<1
-07	Area A, east planter	↓		↓	↓	↓
-08	Area A, NE planter	↓		↓	↓	↓
-09	Area A, SE planter	Brick and mortar	Area A (Lunch area between Bldg B and Bldg D) cap piece on planters	3	60SR	<1
-10	Area A, center-west planter	↓		↓	↓	↓
-11	Area A, NW planter	↓		↓	↓	↓

Notes:

Released By, Date, & Time: <u>Rhys 02/18/2023 01205PM</u>	Received By, Date, & Time: <u>havel</u>	Released By, Date, & Time:
	2/18/2023 1:10 PM	

923021364



Industrial Hygiene Laboratory Submittal Asbestos -- PLM

Originating Office

☒ 310 E. Foothill Blvd., Suite 200
Arcadia, CA 91006
Phone: 626.441.7050
Fax: 626.441.0016

Lab Submitted to:

☒ AmeriSci
☐ EMLab (Glendale)
☐ LA Testing

☒ Routine
(3 Working Days)

☐ RUSH (surcharges may apply)
Circle 6 24 48 3 to 5
One hours hours hours days

Project #:
23-Z0046-0030

Sampled by:
Rhys Kuzmic

Site Zip Code:
91770

Sample Date:
02/17/2023

Page 3 of 9

The receiving Laboratory is required to complete the following:

1. All invoices are to be sent to: 310 E. Foothill Blvd., Suite 200, Arcadia, CA 91006 with a copy of the lab report.
2. Analyze all samples by PLM by EPA 600/R-93/116.
3. Stop analysis of homogeneous groups at first positive that is greater than or equal to 1.0%

Building Name: Campus

4. All lab reports and invoices are to contain the Project Number from above.
5. Unsigned and reports marked draft are unacceptable.
6. Report to the attention of: Yesenia Galeana, Phone: (562) 889-1327

Optional Items to be completed by the laboratory (if check marked): ☒

Email Report to: ☒ Info@execenv.com ☒ Other: ygaleana@execenv.com

☒ US Mail Report to: ☒ Originating office check marked above ☐ Other:

☐ Alternate billing address:

Sample No.:	Sample Location – Include Room information where appropriate	Material Description	Homogeneous Location	No.	Quantity	Percent Damaged
-12	Area A, SE planter	Cinderblock and mortar	Area A (Lunch area between Bldg B and Bldg D) planters	4	250 SF	0
-13	Area A, center-west planter	(behind stucco)				
-14	Area A, NW planter	↓		↓	↓	↓
-15	Area A, center-west planter at brick	Caulking	Area A (Lunch area between Bldg B and Bldg D) center-west planter at brick and stucco	5	1 SF	0
-16	Area A, center-west planter at brick					
-17	Area A, center-west planter at stucco	↓		↓	↓	↓

Prefix: 2302170030RK

Notes:

Released By, Date, & Time:

Rhys Kuzmic 02/18/2023 1:05 PM

Received By, Date, & Time:

2/18/2023 1:10 PM

Released By, Date, & Time:



Industrial Hygiene Laboratory Submittal Asbestos -- PLM

Originating Office

☒ 310 E. Foothill Blvd., Suite 200
Arcadia, CA 91006
Phone: 626.441.7050
Fax: 626.441.0016

Lab Submitted to:

☒ AmeriSci
☐ EMLab (Glendale)
☐ LA Testing

☒ Routine
(3 Working Days)

☐ RUSH (surcharges may apply)
Circle 6 24 48 3 to 5
One hours hours hours days

Project #:
23-Z0046-0030

Sampled by:
Rhys Kuzmic

Site Zip Code:
91770

Sample Date:
02/17/2023

Page 4 of 9

The receiving Laboratory is required to complete the following:

1. All invoices are to be sent to: 310 E. Foothill Blvd., Suite 200, Arcadia, CA 91006 with a copy of the lab report.
2. Analyze all samples by PLM by EPA 600/R-93/116.
3. Stop analysis of homogeneous groups at first positive that is greater than or equal to 1.0%

Building Name: Campus

4. All lab reports and invoices are to contain the Project Number from above.
5. Unsigned and reports marked draft are unacceptable.
6. Report to the attention of: Yesenia Galeana, Phone: (562) 889-1327

Optional Items to be completed by the laboratory (if check marked): ☒ Email Report to: ☒ Info@execenv.com ☒ Other: ygaleana@execenv.com;

☒ US Mail Report to: ☒ Originating office check marked above ☐ Other: ☐ Alternate billing address:

Sample No.:	Sample Location – Include Room information where appropriate	Material Description	Homogeneous Location	No.	Quantity	Percent Damaged
-18	Area B, NW	Concrete walkway	Area B (South of Bldg A/X Administration)	6	300 SF	0
-19	Area B, NE			↓	↓	↓
-20	Area B, south	↓		↓	↓	↓
-21	Area B, north between concrete and buildings	Expansion joint	Area B (South of Bldg A/X Administration) between concrete and building	7	2 SF	0
-22	Area B, north between concrete and building	↓		↓	↓	↓
-23	Area B, north between concrete and buildings	↓		↓	↓	↓

Notes:

Released By, Date, & Time:	Rhys Kuz 02/18/2023 1:05 PM	Received By, Date, & Time:	<i>arguel</i>	Released By, Date, & Time:	
			2/18/2023 1:10 PM		



Industrial Hygiene Laboratory Submittal Asbestos -- PLM

Originating Office

☒ 310 E. Foothill Blvd., Suite 200
Arcadia, CA 91006
Phone: 626.441.7050
Fax: 626.441.0016

Lab Submitted to:

☒ AmeriSci
☐ EMLab (Glendale)
☐ LA Testing

☒ Routine
(3 Working Days)

☐ RUSH (surcharges may apply)
Circle 6 24 48 3 to 5
One hours hours hours days

Project #:
23-Z0046-0030

Sampled by:
Rhys Kuzmic

Site Zip Code:
91770

Sample Date:
02/17/2023

Page 5 of 9

The receiving Laboratory is required to complete the following:

1. All invoices are to be sent to: 310 E. Foothill Blvd., Suite 200, Arcadia, CA 91006 with a copy of the lab report.
2. Analyze all samples by PLM by EPA 600/R-93/116.
3. Stop analysis of homogeneous groups at first positive that is greater than or equal to 1.0%

Building Name: Campus

4. All lab reports and invoices are to contain the Project Number from above.
5. Unsigned and reports marked draft are unacceptable.
6. Report to the attention of: Yesenia Galeana, Phone: (562) 889-1327

Optional Items to be completed by the laboratory (if check marked): ☒ Email Report to: ☒ Info@execenv.com ☒ Other: ygaleana@execenv.com;

☒ US Mail Report to: ☒ Originating office check marked above ☐ Other:

☐ Alternate billing address:

Sample No.:	Sample Location – Include Room information where appropriate	Material Description	Homogeneous Location	No.	Quantity	Percent Damaged
-24	Area C, SW	Concrete Walkway	Area C (walkway near entry to Bldg A/X Administration)	8	250 SF	0
-25	Area C, SE	↓		↓	↓	↓
-26	Area C, NW	↓		↓	↓	↓
-27	Area D, SW	Concrete Walkway	Area D (walkway at handicap entry from parking lot east of Bldg D)	9	170 SF	0
-28	Area D, West	↓		↓	↓	↓
-29	Area D, North	↓		↓	↓	↓

Notes:

Released By, Date, & Time: Rhys Kuz 02/18/2023 1:05 PM	Received By, Date, & Time: [Signature] 2/18/2023 1:10 PM	Released By, Date, & Time:
--	--	----------------------------

923021364



Industrial Hygiene Laboratory Submittal Asbestos -- PLM

Originating Office

☒ 310 E. Foothill Blvd., Suite 200
Arcadia, CA 91006
Phone: 626.441.7050
Fax: 626.441.0016

Lab Submitted to:

☒ AmeriSci
☐ EMLab (Glendale)
☐ LA Testing

☒ Routine
(3 Working Days)

☐ RUSH (surcharges may apply)
Circle 6 24 48 3 to 5
One hours hours hours days

Project #:
23-Z0046-0030

Sampled by:
Rhys Kuzmic

Site Zip Code:
91770

Sample Date:
02/17/2023

Page 6 of 9

The receiving Laboratory is required to complete the following:

1. All invoices are to be sent to: 310 E. Foothill Blvd., Suite 200, Arcadia, CA 91006 with a copy of the lab report.
2. Analyze all samples by PLM by EPA 600/R-93/116.
3. Stop analysis of homogeneous groups at first positive that is greater than or equal to 1.0%

Building Name: Campus

4. All lab reports and invoices are to contain the Project Number from above.
5. Unsigned and reports marked draft are unacceptable.
6. Report to the attention of: Yesenia Galeana, Phone: (562) 889-1327

Optional Items to be completed by the laboratory (if check marked): ☒

Email Report to: ☒ info@execenv.com ☒ Other: ygaleana@execenv.com

☒ US Mail Report to: ☒ Originating office check marked above ☐ Other:

☐ Alternate billing address:

Sample No.:	Sample Location – Include Room information where appropriate	Material Description	Homogeneous Location	No.	Quantity	Percent Damaged
-30	Area D, SE at parking lot	Asphalt pavings	Area D (walkway) at handi cap entry from parking lot east of Bldg D) adjoining parking lot	10	2055	0
-31	Area D, east at parking lot	↓		↓	↓	↓
-32	Area D, NE at parking lot			↓	↓	↓

Prefix: 2302170030RK

Notes:

Released By, Date, & Time:

Rhys Kuzmic 02/18/2023 1:05 PM

Received By, Date, & Time:

2/18/2023 1:10 PM

Released By, Date, & Time:



Industrial Hygiene Laboratory Submittal Asbestos -- PLM

Originating Office

☒ 310 E. Foothill Blvd., Suite 200
Arcadia, CA 91006
Phone: 626.441.7050
Fax: 626.441.0016

Lab Submitted to:

☒ AmeriSci
☐ EMLab (Glendale)
☐ LA Testing

☒ Routine
(3 Working Days)

☐ RUSH (surcharges may apply)
Circle 6 24 48 3 to 5
One hours hours hours days

Project #:
23-Z0046-0030

Sampled by:
Rhys Kuzmic

Site Zip Code:
91770

Sample Date:
02/17/2023

Page 7 of 9

The receiving Laboratory is required to complete the following:

1. All invoices are to be sent to: 310 E. Foothill Blvd., Suite 200, Arcadia, CA 91006 with a copy of the lab report.
2. Analyze all samples by PLM by EPA 600/R-93/116.
3. Stop analysis of homogeneous groups at first positive that is greater than or equal to 1.0%

Building Name: Bldg E Restrooms

4. All lab reports and invoices are to contain the Project Number from above.
5. Unsigned and reports marked draft are unacceptable.
6. Report to the attention of: Yesenia Galeana, Phone: (562) 889-1327

Optional Items to be completed by the laboratory (if check marked): ☒ Email Report to: ☒ Info@execenv.com ☒ Other: ygaleana@execenv.com;

☒ US Mail Report to: ☒ Originating office check marked above ☐ Other:

☐ Alternate billing address:

Sample No.:	Sample Location - Include Room information where appropriate	Material Description	Homogeneous Location	No.	Quantity	Percent Damaged
-33	Boys' Restroom, west wall	4" ceramic wall tile with grout and thinset	Boys' Restroom west wall around NW corner on drywall	11	20 SF	0
-34	Boys' Restroom, west wall	↓	Exterior south wall around drinking fountains on stucco	↓	↓	↓
-35	Exterior, south wall around drinking fountains			↓	↓	↓
-36	Boys' Restroom, west wall	Drywall no joint compound behind ceramic wall tile	Boys' Restroom west wall around NW corner	12	10 SF	0
-37	Boys' Restroom, west wall	↓		↓	↓	↓
-38	Boys' Restroom, west wall			↓	↓	↓

Notes:

Released By, Date, & Time:	Rm K2 02/18/2023 1:05 PM	Received By, Date, & Time:	2/18/2023 1:10 PM	Released By, Date, & Time:	
----------------------------	--------------------------	----------------------------	-------------------	----------------------------	--



Industrial Hygiene Laboratory Submittal Asbestos -- PLM

Originating Office

☒ 310 E. Foothill Blvd., Suite 200
Arcadia, CA 91006
Phone: 626.441.7050
Fax: 626.441.0016

Lab Submitted to:

☒ AmeriSci
☐ EMLab (Glendale)
☐ LA Testing

☒ Routine
(3 Working Days)

☐ RUSH (surcharges may apply)
Circle 6 24 48 3 to 5
One hours hours hours days

Project #:
23-Z0046-0030

Sampled by:
Rhys Kuzmic

Site Zip Code:
91770

Sample Date:
02/17/2023

Page 8 of 9

The receiving Laboratory is required to complete the following:

1. All invoices are to be sent to: 310 E. Foothill Blvd., Suite 200, Arcadia, CA 91006 with a copy of the lab report.
2. Analyze all samples by PLM by EPA 600/R-93/116.
3. Stop analysis of homogeneous groups at first positive that is greater than or equal to 1.0%

Building Name: Bldg E Restrooms

4. All lab reports and invoices are to contain the Project Number from above.
5. Unsigned and reports marked draft are unacceptable.
6. Report to the attention of: Yesenia Galeana, Phone: (562) 889-1327

Optional Items to be completed by the laboratory (if check marked): ☒ Email Report to: ☒ Info@execenv.com ☒ Other: ygaleana@execenv.com;

☒ US Mail Report to: ☒ Originating office check marked above ☐ Other:

☐ Alternate billing address:

Sample No.:	Sample Location - Include Room information where appropriate	Material Description	Homogeneous Location	No.	Quantity	Percent Damaged
-39	Boys' Restroom, west wall at NW window	Caulking around window	Boys' Restroom west wall NW window	13	1 SF	0
-40	Boys' Restroom, west wall at NW window	↓		↓	↓	↓
-41	Boys' Restroom, west wall at NW window			↓	↓	↓
-42	Exterior, south wall around drinking fountains		Exterior south wall around drinking fountains	14	10 SF	0
-43	Exterior, south wall around drinking fountains	↓		↓	↓	↓
-44	Exterior, south wall around drinking fountains			↓	↓	↓

Prefix: 2302170030RK

Notes:

Released By, Date, & Time:

Rhys Kuz 02/18/2023 1:05 PM

Received By, Date, & Time:

2/18/2023 1:10 PM

Released By, Date, & Time:

923021364



Industrial Hygiene Laboratory Submittal Asbestos -- PLM

Originating Office

☒ 310 E. Foothill Blvd., Suite 200
Arcadia, CA 91006
Phone: 626.441.7050
Fax: 626.441.0016

Lab Submitted to:

☒ AmeriSci
☐ EMLab (Glendale)
☐ LA Testing

☒ **Routine**
(3 Working Days)

☐ **RUSH** (surcharges may apply)
Circle 6 24 48 3 to 5
One hours hours hours days

Project #:
23-Z0046-0030

Sampled by:
Rhys Kuzmic

Site Zip Code:
91770

Sample Date:
02/17/2023

Page 9 of 9

The receiving Laboratory is required to complete the following:

1. All invoices are to be sent to: 310 E. Foothill Blvd., Suite 200, Arcadia, CA 91006 with a copy of the lab report.
2. Analyze all samples by PLM by EPA 600/R-93/116.
3. Stop analysis of homogeneous groups at first positive that is greater than or equal to 1.0%

Building Name: Bldg E Restrooms

4. All lab reports and invoices are to contain the Project Number from above.
5. Unsigned and reports marked draft are unacceptable.
6. Report to the attention of: Yessenia Galeana, Phone: (562) 889-1327

Optional Items to be completed by the laboratory (if check marked): ☒

Email Report to: ☒ Info@execenv.com

☒ Other: ygaleana@execenv.com

☒ US Mail Report to: ☒ Originating office check marked above ☐ Other:

☐ Alternate billing address:

Sample No.:	Sample Location – Include Room information where appropriate	Material Description	Homogeneous Location		No.	Quantity	Percent Damaged
-45	Exterior, south wall ground drinking fountains	Cementitious layer behind	Exterior south wall ground drinking fountains		15	10 SF	0
-46	Exterior, south wall ground drinking fountains	stucco behind ceramic wall tiles			↓	↓	↓
-47	Exterior, south wall ground drinking fountains	↓			↓	↓	↓
-48	Exterior, south wall ground drinking fountains	Vapor barrier paper - 2 type	Exterior south wall ground drinking fountains		16	10 SF	0
-49	Exterior, south wall ground drinking fountains	behind cementitious layer			↓	↓	↓
-50	Exterior, south wall ground drinking fountains	↓			↓	↓	↓

Notes:

Released By, Date, & Time:	Rhys Kuz 02/18/2023 1:05PM	Received By, Date, & Time:	Wauel	Released By, Date, & Time:	
			2/18/2023 1:10 PM		

APPENDIX B – SAMPLE/ACM LOCATIONS DRAWING

Muscatel Middle School

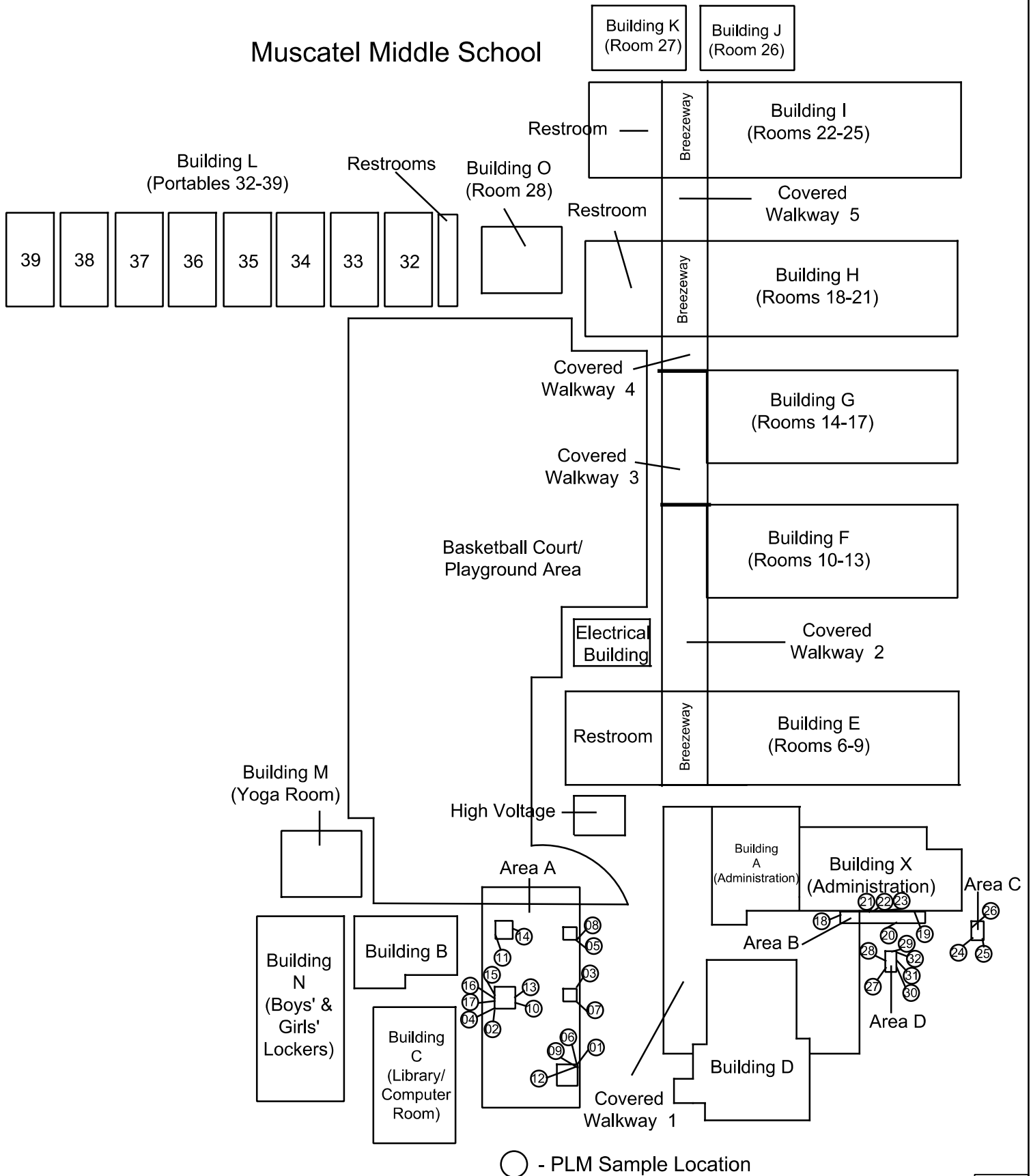

Client: Rosemead School District

Project#: 23-Z0046-0030

Info: PLM Sample Locations



EXECUTIVE ENVIRONMENTAL
HEALTH & SAFETY SIMPLIFIED

Site: Muscatel Middle School
Address: 4201 Ivar Avenue
Rosemead, California 91770

Drawing Not to Scale - © 2012

Building E Restrooms Exterior

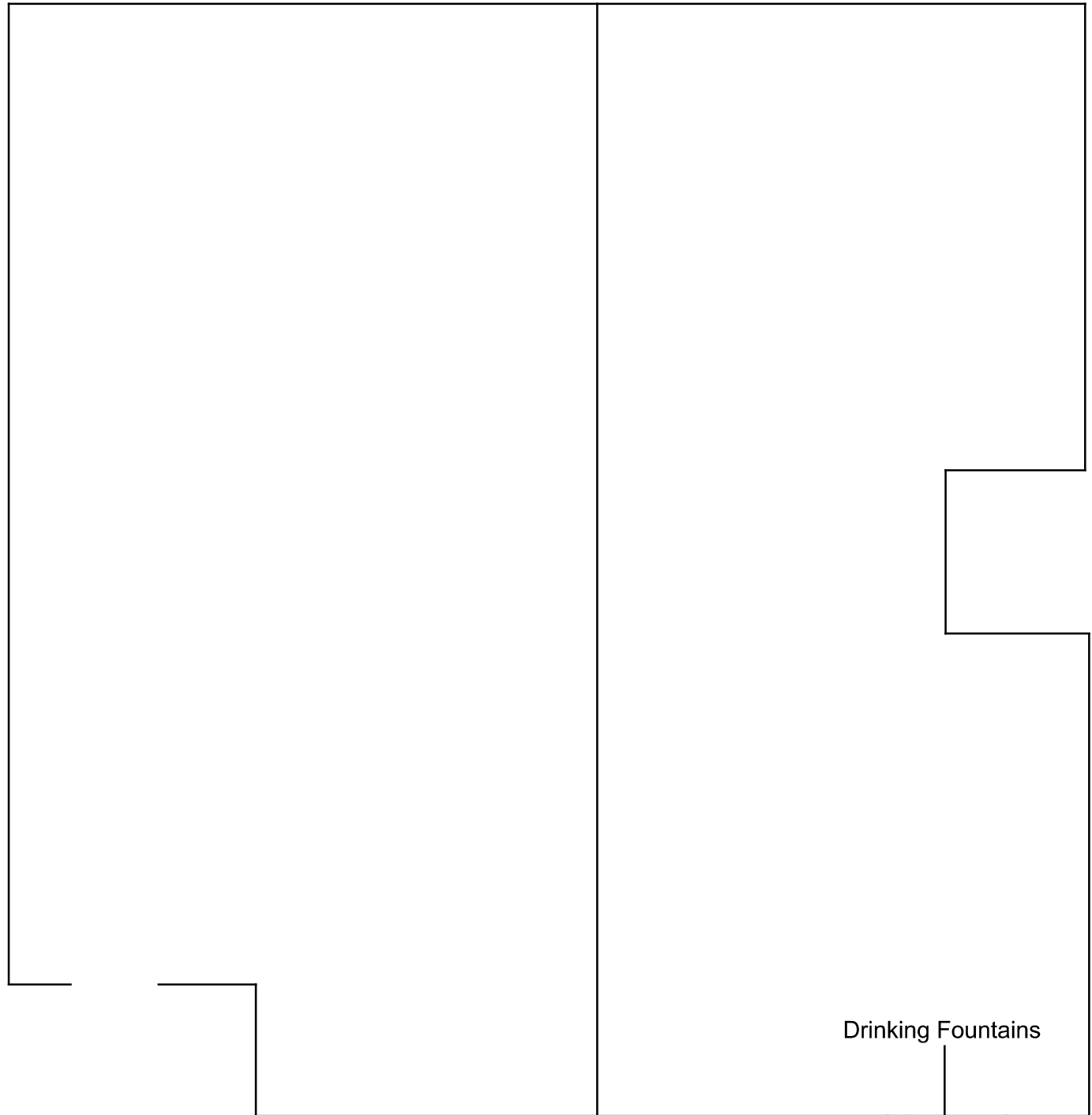

○ - PLM Sample Location
NIS - Not in Scope

Drinking Fountains

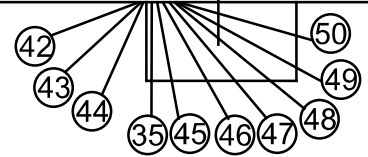

Client: Rosemead School District

Project#: 23-Z0046-0030

Info: PLM Sample Locations



EXECUTIVE ENVIRONMENTAL
HEALTH & SAFETY SIMPLIFIED

Site: Muscatel Middle School
Address: 4201 Ivar Avenue
Rosemead, California 91770

Drawing Not to Scale - © 2012

Building E Restrooms Interior

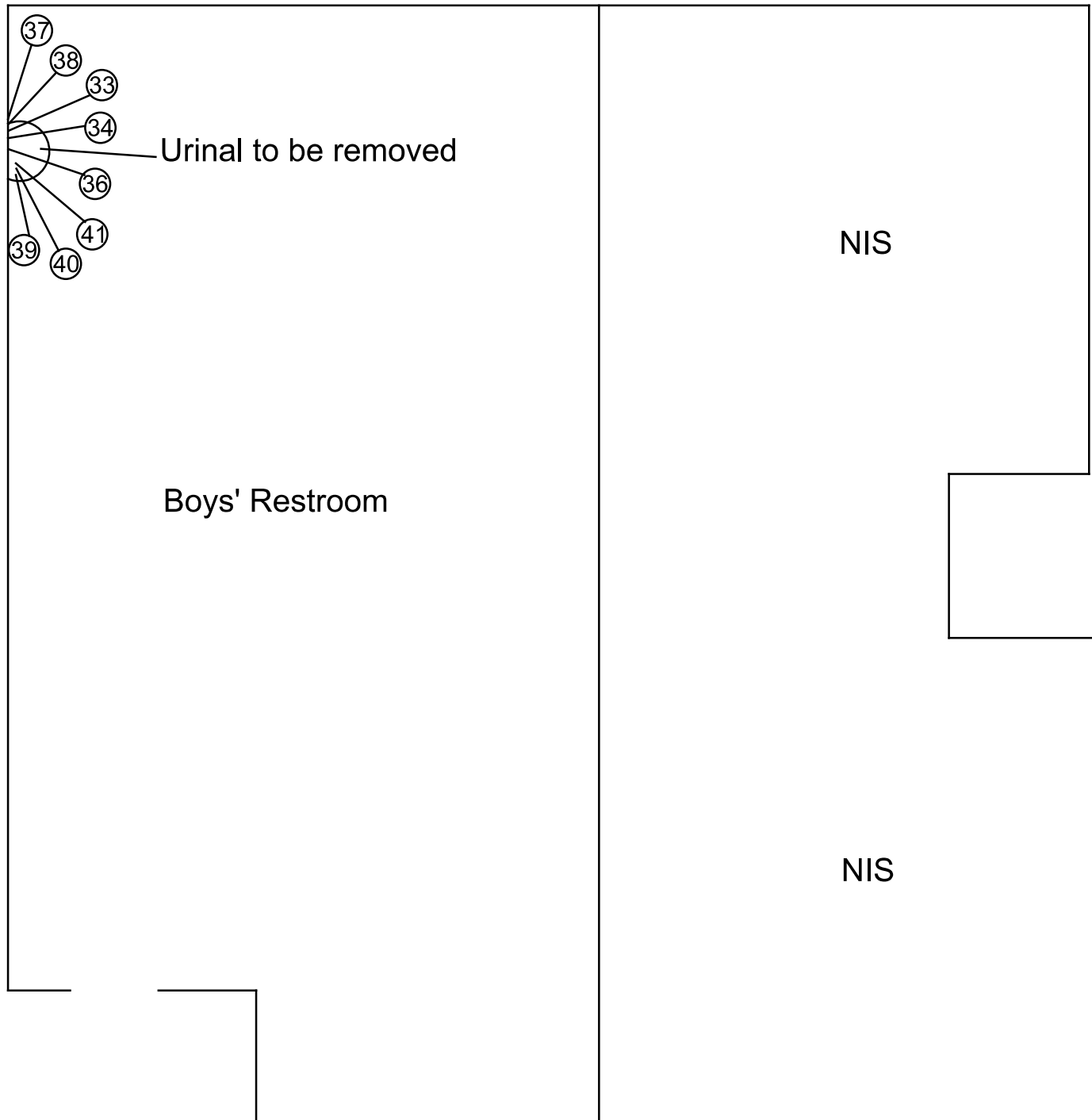

○ - PLM Sample Location
NIS - Not in Scope



Client: Rosemead School District

Project#: 23-Z0046-0030

Info: PLM Sample Locations



EXECUTIVE ENVIRONMENTAL
HEALTH & SAFETY SIMPLIFIED

Site: Muscatel Middle School
Address: 4201 Ivar Avenue
Rosemead, California 91770

Drawing Not to Scale - © 2012

APPENDIX C – STAFF CERTIFICATION

State of California
Division of Occupational Safety and Health
Certified Asbestos Consultant

Rhys D Kuzmic

Name

Certification No. **09-4586**

Expires on **01/20/24**



This certification was issued by the Division of Occupational Safety and Health as authorized by Sections 7180 et seq. of the Business and Professions Code.